

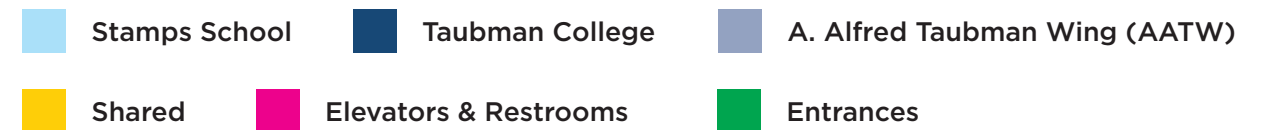

1ST FLOOR

Stamps Senior Studios	1000	FABLab	1205, 1210, 1219, 1234, 1240, 1242
Fibers - Dye, Sewing, and Project Room	1068, 1075B, 1076	Building Technology (BT) Lab	1221
Maskell Metals/Jewelry	1069, 1069A	MS Studio	1248
Stamps Digital Fabrication	1070, 1071, 1074	Student Research Room	1203
Computational Media Studio - 2D, 3D, 4D	1108	Classroom	1360 AATW
Sculpture - Studio, Metal-forming, Cutting & Welding, Foundry, Plaster	1258A, 1258B, 1262, 1260, 1259	Development + Alumni Engagement	1342, 1344, 1346 AATW
Ceramics - Studio, Kiln Room	1269, 1270	Vending	1100
Studio Suites 1 -		Loading Dock	1105
The Gorman Family Studio,	1410	Woodshop	1251
Instructional Studio,	1420	Art & Architecture Auditorium	2104
Ann and Bob Aikens Commons,	1430		
Seminar Room	1450		

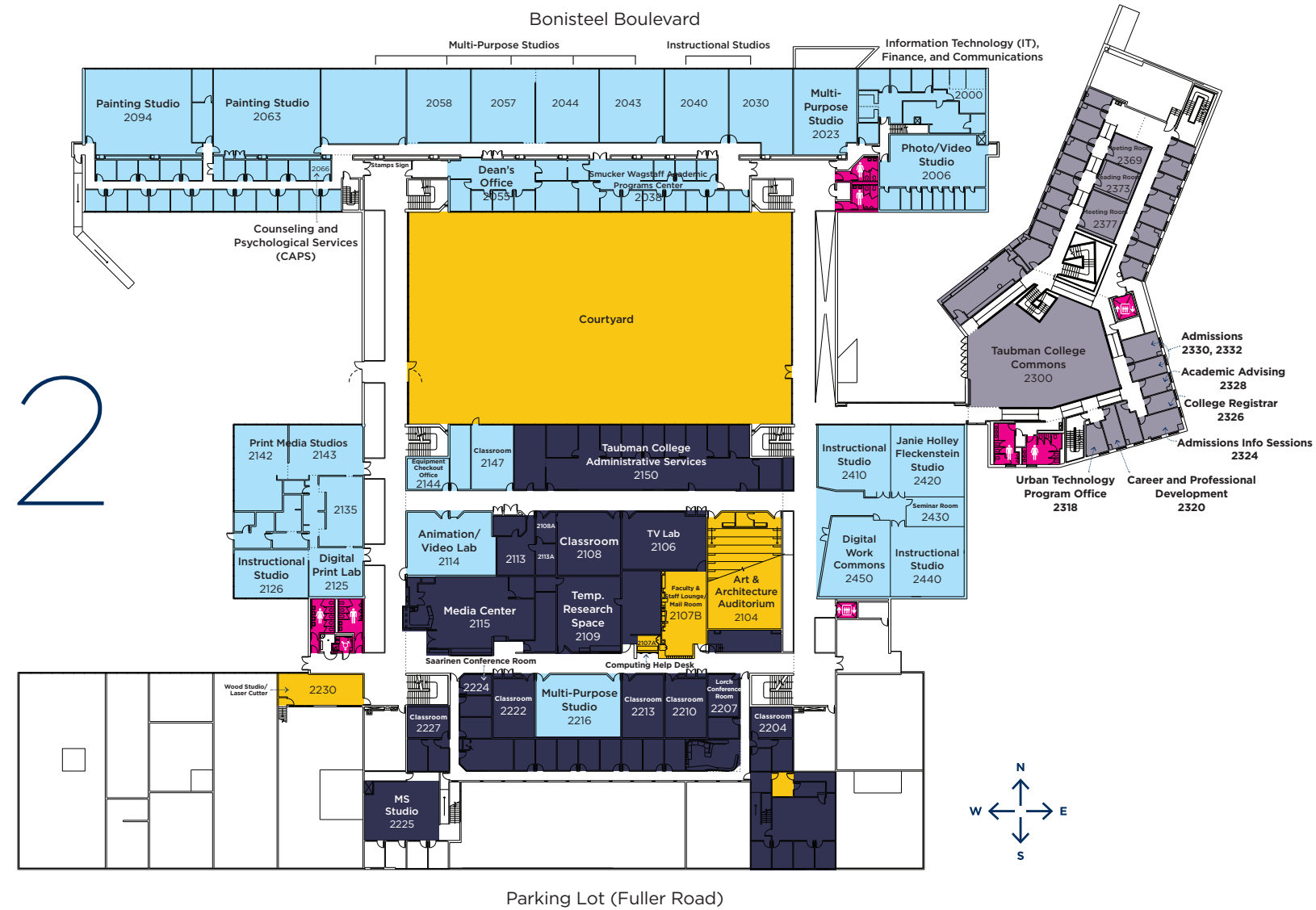



Parking Lot (Fuller Road)

2ND FLOOR

Information Technology (IT), Finance, and Communications	2000	Studio Suites 2 -		Academic Advising
Photo/Video Studio	2006	Instructional Studio,	2410	Admissions
Instructional Studios - 2D, 3D, 4D	2030, 2040	Janie Holley Fleckenstein Studio,	2420	Admissions Info Sessions
Smucker Wagstaff Academic Programs Center (SWAPC)	2038	Seminar Room,	2430	Career + Professional Development
Stamps School Dean's Office	2055	Instructional Studio,	2440	College Registrar
Multi-Purpose Studios - 2D, 3D, 4D	2023, 2043, 2044 2057, 2058, 2062	Digital Work Commons	2450	Meeting Rooms
Painting Studios	2063, 2094			Reading Room
Animation/Video Lab	2114			Taubman College Commons
Digital Print Lab	2125			Urban Technology Program Office
Instructional Studio, Classroom	2126, 2147	Taubman College Administrative Offices	2150	
Print Media Studios	2135, 2142, 2143	• Marketing and Communications		
Equipment Checkout Office	2144	• Dean's Office		
Multi-Purpose Studio - 2D, 3D, 4D	2216	• Development and Alumni Relations		
		• Program Chairs		
		Business + Finance	2113	Art & Architecture Auditorium
		Lorch Conference Room	2207	Computing Help Desk
		Media Center	2115	Counseling and Psychological Services (CAPS)
		MS Studio	2225	Courtyard
		Saarinen Conference Room	2224	Faculty & Staff Lounge/Mail Room
		Temporary Research Space	2109	Laser Cutter
		TV Lab	2106	

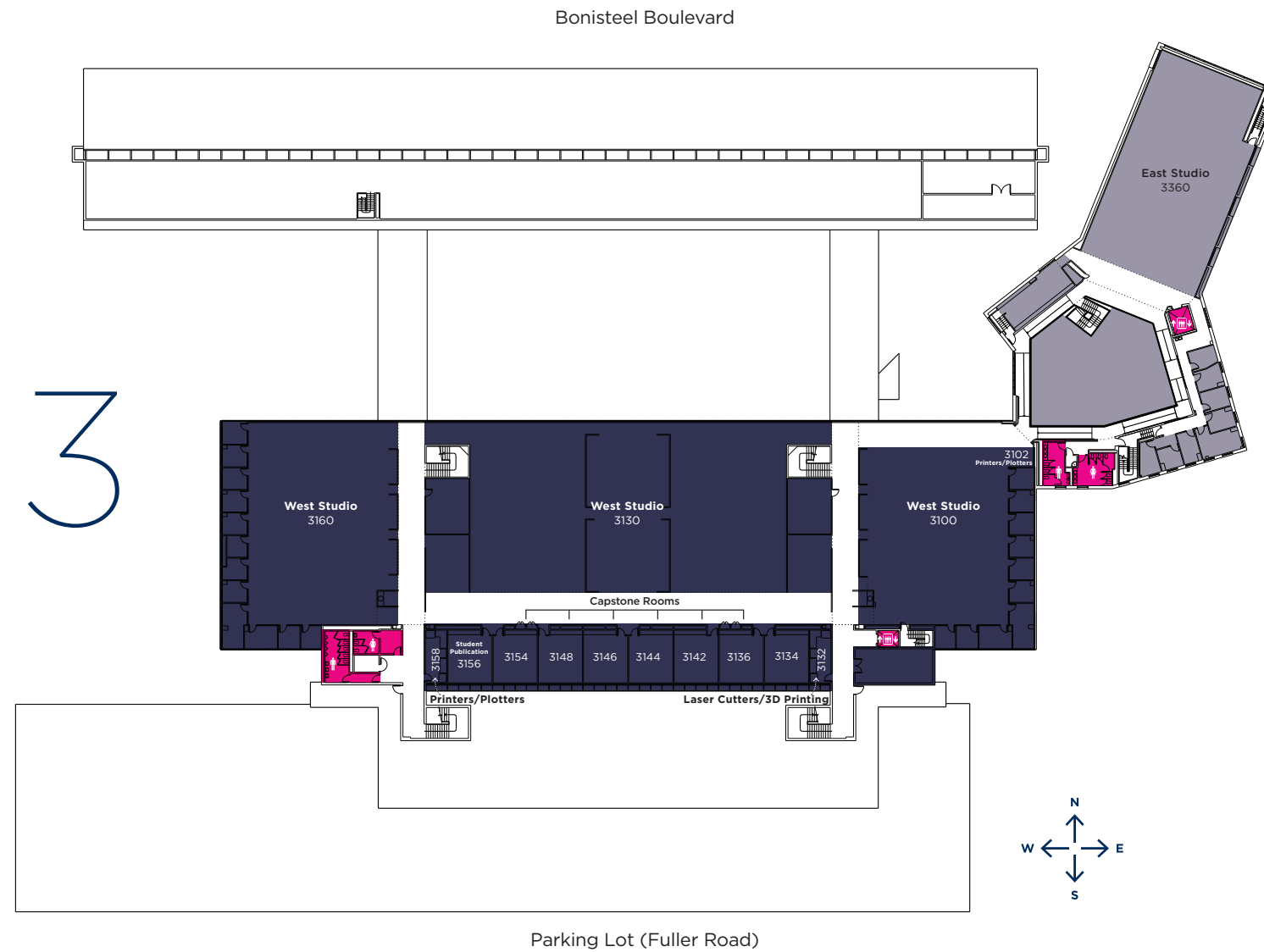

3RD FLOOR

Capstone Rooms	3136, 3142, 3144, 3146, 3148, 3154
Laser Cutters/3D Printing	3132
Printers/Plotters	3102, 3158
Student Publications	3156
West Studio	3100, 3130, 3160
East Studio	3360 AATW